

Staff Report 23

LESSEE:

Jo'anne N. Zschokke, as Trustee of the Phillip B. and Jo'anne N. Zschokke Revocable Intervivos Trust, under Trust agreement dated December 15, 1999; Jim Stehr and Danya Stehr, as Trustees for the Stehr 2000 Revocable Trust; and Edgar G. Protiva and Audrey N. Protiva, as Trustees of the Protiva 1995 Trust dated October 24, 1995

APPLICANT:

2895 West Lake LLC, a California Limited Liability Company

PROPOSED ACTION:

Termination and Issuance of a General Lease – Recreational Use.

AREA, LAND TYPE, AND LOCATION:

Sovereign land located in Lake Tahoe, adjacent to 2895 West Lake Boulevard, near Homewood, Placer County (as shown in Figure 1).

Figure 1. Location

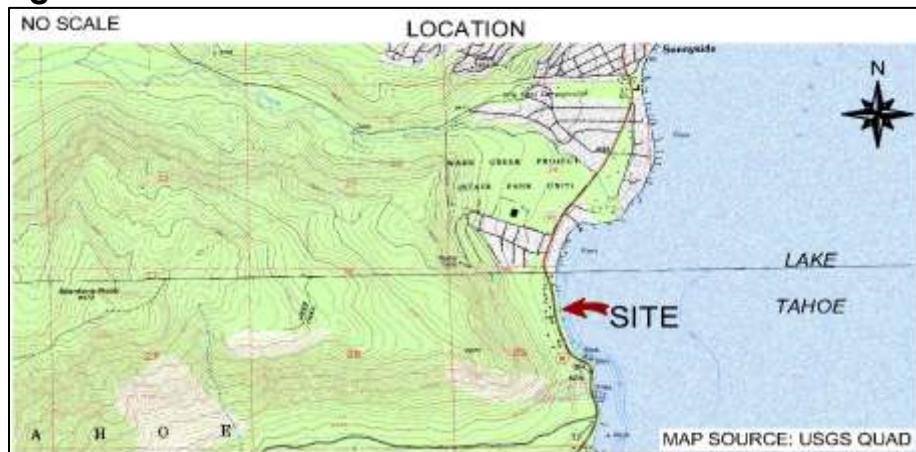

AUTHORIZED USE:

Removal of an existing pier and boathouse and use of two existing mooring buoys (as shown in Figure 2).

Figure 2. Site Map

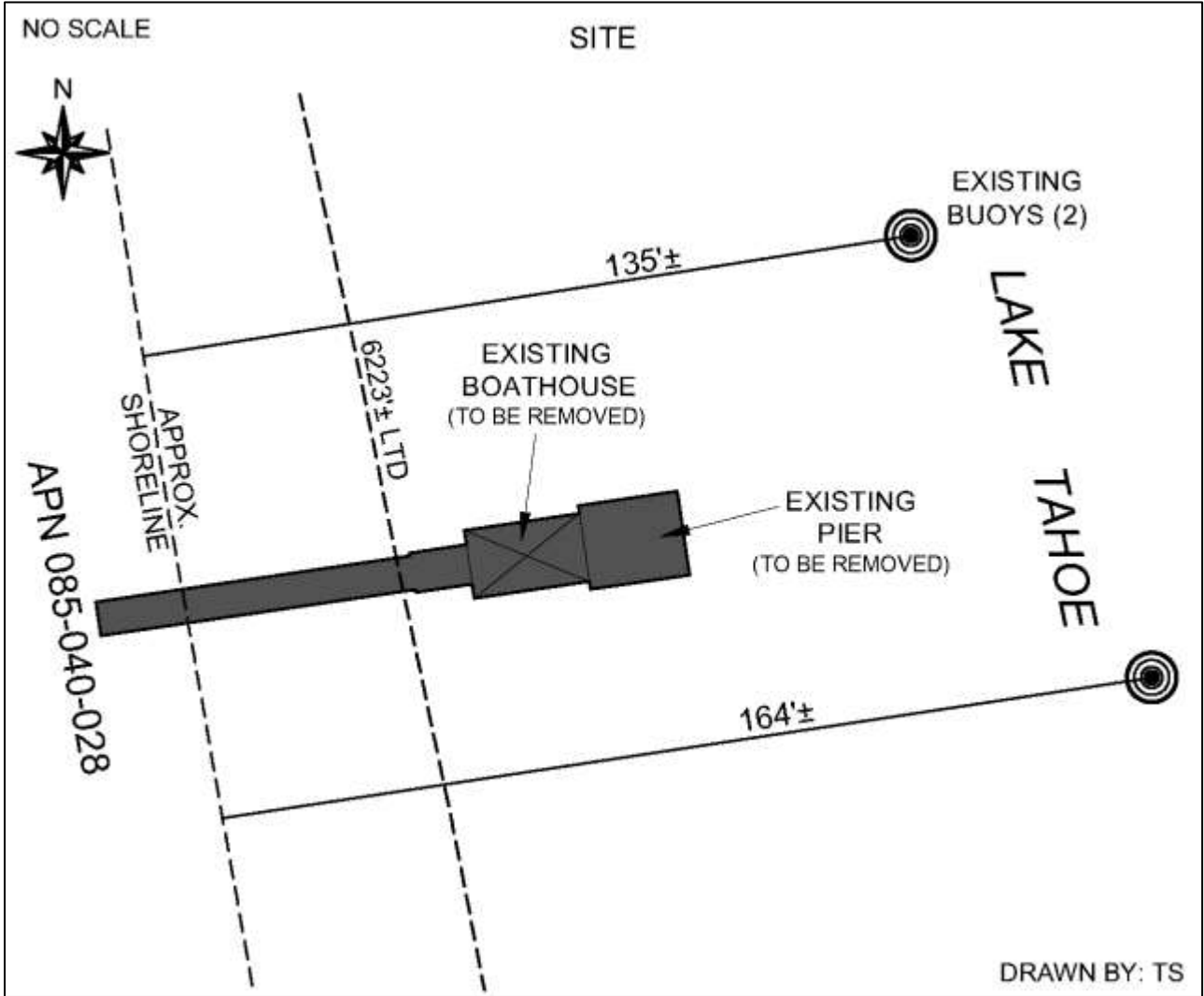

NOTE: This depiction of the lease premises is based on unverified information provided by the Applicant or other parties and is not a waiver or limitation of any State interest in the subject or any other property.

TERM:

10 years, beginning April 7, 2026.

CONSIDERATION:

\$546 per year, with an annual Consumer Price Index adjustment.

SPECIFIC LEASE PROVISIONS:

- A permit or registration from the Tahoe Regional Planning Agency (TRPA) may be required for the Authorized Improvements, and failure to obtain a permit or registration from TRPA and maintain compliance with that permit or registration may result in TRPA imposing civil penalties and will constitute a breach of the lease.
- Lessee shall not move or relocate the existing mooring buoy authorized under this lease without prior written authorization of the Lessor.
- Lessee shall not store any personal items or construct any improvements in the Public Trust easement which may impair the public's right of access for navigation, fishing, and Public Trust-consistent recreational uses.
- Lessee shall provide photographs of the construction area before and after removal of the pier; and restore the land to its natural condition. Removal of the pier can begin upon Lessee's receipt of all required approvals and permits from the appropriate regulatory bodies and Lessee must complete the removal no later than December 31, 2026.
- The provisions of Section 3, Paragraph 11 shall also extend to the period of Lessee's unauthorized occupation of state-owned lands, from February 4, 2025, to April 6, 2026.

STAFF ANALYSIS AND RECOMMENDATION:

AUTHORITY:

Public Resources Code sections 6005, 6216, 6301, 6501.1, 6503, 6503.5, and 6505.5; California Code of Regulations, title 2, section 2000 and 2003.

PUBLIC TRUST AND STATE'S BEST INTERESTS:

On June 28, 2019, the Commission authorized issuance of a General Lease – Recreational Use to Jo'anne N. Zschokke, as Trustee of the Phillip B. and Jo'anne N. Zschokke Revocable Intervivos Trust, under Trust agreement dated December 15, 1999; Jim Stehr and Danya Stehr, as Trustees for the Stehr 2000 Revocable Trust; and Edgar G. Protiva and Audrey N. Protiva, as Trustees of the Protiva 1995 Trust dated October 24, 1995 (Lessee), for the use and maintenance of an existing pier, boathouse, and two mooring buoys ([Item 22](#)). That lease is set to expire on June 26, 2029.

On February 4, 2025, the Lessee conveyed the ownership of the upland parcel to 2895 West Lake LLC, a California Limited Liability Company. Staff recommends terminating the lease because the Lessee did not notify staff of the sale of the upland parcel or sign a quitclaim deed. The proposed termination date is April 6, 2026, the day preceding the start of the proposed new lease.

The Applicant is now applying for issuance of a General Lease – Recreational Use for the removal of an existing pier and boathouse and continued use of two existing mooring buoys. Both mooring buoys were registered with TRPA on February 16, 2026 (Registration No. 10355).

Accounting records for Lease 3132 show rent is paid through June 27, 2026. The proposed start date of the new lease is April 7, 2026. The prorated rent will be applied as a credit to future rent. Additionally, the proposed lease will require the Applicant to indemnify the State for the entire period of unauthorized occupation, from February 4, 2025 through April 6, 2026, ensuring the State is protected.

On February 23, 2026, the Applicant obtained a conditional permit No. ESRP2025-1286 from TRPA authorizing the removal of the existing pier and boathouse.

The pier demolition will be conducted via a barge from the lake complying with all TRPA-identified measures and best management practices, such as working within identified work windows, installing turbidity curtains, implementing spill prevention measures, and disposing of the removed pier at a TRPA-approved disposal facility. A front loader or similar equipment will be stored on the barge for the demolition. At no time during construction shall any equipment be stored/staged along the shoreline. Vehicular access from the upland to the shoreline shall be prohibited, as this project area is located in Shorezone Tolerance District 6. The pier removal must be completed by December 31, 2026.

The two mooring buoys have existed for many years at this location. The Applicant owns the uplands adjoining the lease premises. The subject facilities are privately owned and maintained and facilitate recreational boating. Recreational boating is a water-dependent use that is generally consistent with the common law Public Trust Doctrine. The California Legislature has identified private recreational boating facilities as an authorized use of Public Trust land. (Pub. Resources Code, § 6503.5.)

The proposed lease does not alienate the State's fee simple interest or permanently impair public rights. The lease is limited to a 10-year term, does not grant the lessee exclusive rights to the lease premises, and reserves an easement to the public for Public Trust-consistent uses. Upon termination of the lease, the lessee may be

required to remove all improvements from State land and restore the lease premises to their original condition.

The proposed lease requires the lessee to insure the lease premises and indemnify the State for any liability incurred as a result of the lessee's activities thereon. The lease also requires the payment of annual rent to compensate the people of the State for the occupation of the public land involved.

CLIMATE CHANGE:

INTRODUCTION:

Climate change significantly affects inland non-tidal lakes such as Lake Tahoe, and its effects are increasing throughout the Sierra Nevada mountains. According to [California's Fourth Climate Change Assessment](#) (2018), the most significant impacts of climate change in the Sierra Nevada Region are more intense heat, precipitation extremes, declining snowpacks, and changes in streamflow timing. These impacts create hazardous conditions like flooding, landslides, wildfire, drought, extreme heat, and severe storms. Structures along the shores of inland lakes are particularly vulnerable to the more frequent and extreme weather events, year-to-year changes in total precipitation, and shifts in seasonal characteristics.

DATA & PROJECTIONS:

Temperatures in the Sierra Nevada are expected to increase six to ten degrees Fahrenheit on average by the end of the century, causing the snowline to shift upslope 1,500 to 3,000 feet in elevation (California's Fourth Climate Change Assessment, 2018). The long-term warming trend will lead to warmer and shorter winters and longer and drier summers. The warmer winters will reduce winter snowpacks by up to 60 percent across most of the Sierra Nevada and will result in increased winter streamflows and floods and decreased spring and summer runoff. Loss of snowpack is expected to dry soils 15 to 40 percent below their historical norms. Hotter, drier summer seasons and low water years will increase stress to vegetation, elevating wildfire risk and fire severity in the Tahoe Basin.

Dry winters will be punctuated with exceedingly wet years and higher temperatures will result in more rain-on-snow events ([Integrated Vulnerability Assessment of Climate Change in the Lake Tahoe Basin](#), 2020). Atmospheric river systems will become more common. These events produce both flash floods and higher than normal seasonal flooding which may shift earlier in the year. Higher soil moisture will

increase erosion and elevate landslide risk, particularly following intense wildfire seasons.

ANALYSIS:

The greatest vulnerability to recreational facilities is from flooding, landslides, and wildfire hazards (Integrated Vulnerability Assessment of Climate Change in the Lake Tahoe Basin, 2020). The Sierra Nevada is expected to experience year-to-year variability in precipitation and may shift between extreme wet and dry periods. High precipitation years or successive years will result in higher lake levels, causing beaches to narrow and reducing public access. Surface runoff may carry more sediment into the lake, adversely impacting water quality, clarity, and increasing risk of algal blooms ([UC Davis Tahoe Environmental Research Center, 2024](#)). Conversely, low lake levels will become normal during periods of extended drought. Low lake level conditions can create more expansive beaches and increased shoreline access in dry months. However, these conditions could make some shoreline areas too shallow for effective recreational use of piers, boat docks, and mooring buoys. During drought, structures will also be exposed to heat and wind that may accelerate deterioration or reduce the structural integrity of certain structures.

Additionally, atmospheric rivers and extreme weather events are expected to increase in the high Sierra. Storms may deviate from prevailing wind patterns for the region. Wind-driven waves can accelerate shoreline erosion in some areas or cause erosion in areas not typically subject to erosion. Winds can also increase wave damage on structures and boats along the lake.

RECOMMENDATIONS:

Improvements authorized under this lease may require more frequent inspection and maintenance to ensure they are not displaced during storm events. Watercraft moored to buoys, piers, or docks are also vulnerable to high wind events and damaging waves. Replacing older structural components with materials designed to better withstand extreme heat, wind events, and storms can reduce the likelihood of degradation and damage to structures. Any future construction or activities on State land would require a separate authorization from the Commission.

Regular maintenance, as required by the lease, may reduce the risks from extreme temperatures and rain. Pursuant to the proposed lease, the Applicant

acknowledges that the lease premises and adjacent upland are located in an area that may be subject to the effects of climate change.

CONCLUSION:

For all the reasons above, staff believes the issuance of this lease will not substantially interfere with Public Trust needs at this location, at this time, and for the term of the proposed lease; is consistent with the common law Public Trust Doctrine; and is in the best interests of the State.

OTHER PERTINENT INFORMATION:

1. Approval or denial of the application is a discretionary action by the Commission. Each time the Commission approves or rejects a use of sovereign land, it exercises legislatively delegated authority and responsibility as trustee of the State's Public Trust lands as authorized by law. If the Commission denies the application the Applicant may be required to remove the improvements and return the premises to their original condition. The lessee has no right to a new lease or to renewal of any previous lease.
2. This action is consistent with the "Leading Climate Activism" and "Meeting Evolving Public Trust Needs" Strategic Focus Areas of the Commission's 2021-2025 Strategic Plan.
3. Termination of the lease is not a project as defined by the California Environmental Quality Act (CEQA) because it is an administrative action that will not result in direct or indirect physical changes in the environment.

Authority: Public Resources Code section 21065 and California Code of Regulations, title 14, sections 15060, subdivision (c)(3), and 15378, subdivision (b)(5).

4. **Existing Mooring Buoys:** Staff recommends that the Commission find that issuance of the lease is exempt from the requirements of CEQA as a categorically exempt project. The project is exempt under Class 1, Existing Facilities; California Code of Regulations, title 14, section 15301.

Pier Removal: Staff recommends that the Commission find that issuance of the lease is exempt from the requirements of CEQA as a categorically exempt project. The project is exempt under Class 4, Minor Alterations to Land; California Code of Regulations, title 14, section 15304.

Authority: Public Resources Code section 21084 and California Code of Regulations, title 14, section 15061.

RECOMMENDED ACTION:

It is recommended that the Commission:

CEQA FINDING:

Find that issuance of the lease is exempt from the requirements of CEQA pursuant to California Code of Regulations, title 14, section 15061 as a categorically exempt project through the combination of the following exemptions: Class 1, Existing Facilities; California Code of Regulations, title 14, section 15301, and Class 4, Minor Alterations to Land; California Code of Regulations, title 14, section 15304.

PUBLIC TRUST AND STATE'S BEST INTERESTS:

Find that the proposed lease will not substantially impair the public rights to navigation and fishing or substantially interfere with Public Trust needs and values at this location, at this time, and for the term of the lease; is consistent with the common law Public Trust Doctrine; and is in the best interests of the State.

AUTHORIZATION:

1. Authorize termination, effective April 6, 2026, of Lease 3132, a General Lease – Recreational Use, issued to Jo'anne N. Zschokke, as Trustee of the Phillip B. and Jo'anne N. Zschokke Revocable Intervivos Trust, under Trust agreement dated December 15, 1999; Jim Stehr and Danya Stehr, as Trustees for the Stehr 2000 Revocable Trust; and Edgar G. Protiva and Audrey N. Protiva, as Trustees of the Protiva 1995 Trust dated October 24, 1995;
2. Authorize issuance of a General Lease – Recreational Use to the Applicant beginning April 7, 2026, for a term of 10 years, for the removal of an existing pier and boat lift, and use of two existing mooring buoys; annual rent in the amount of \$546, with an annual Consumer Price Index adjustment; and liability insurance in an amount no less than \$1,000,000 per occurrence.