

Staff Report 10

LESSEE/ASSIGNOR:

Tara Kassity and Daniel Kassity

APPLICANT/ASSIGNEE:

Robert C. Ryan, III as Trustee of The Robert C Ryan, III Trust; and Robert C. Ryan, III and Kelly J. Ryan, co-Trustees of the Robert C. and Helen J. Ryan Revocable Trust, dated October 15, 1992

PROPOSED ACTION:

Assignment of a General Lease - Recreational Use.

AREA, LAND TYPE, AND LOCATION:

Sovereign land in Lake Tahoe, adjacent to 6259 North Lake Boulevard, Tahoe Vista, Placer County (as shown in Figure 1).

Figure 1. Location



AUTHORIZED USE:

Use of two mooring buoys and two freshwater intake pipelines (as shown in Figure 2).

Figure 2. Site Map

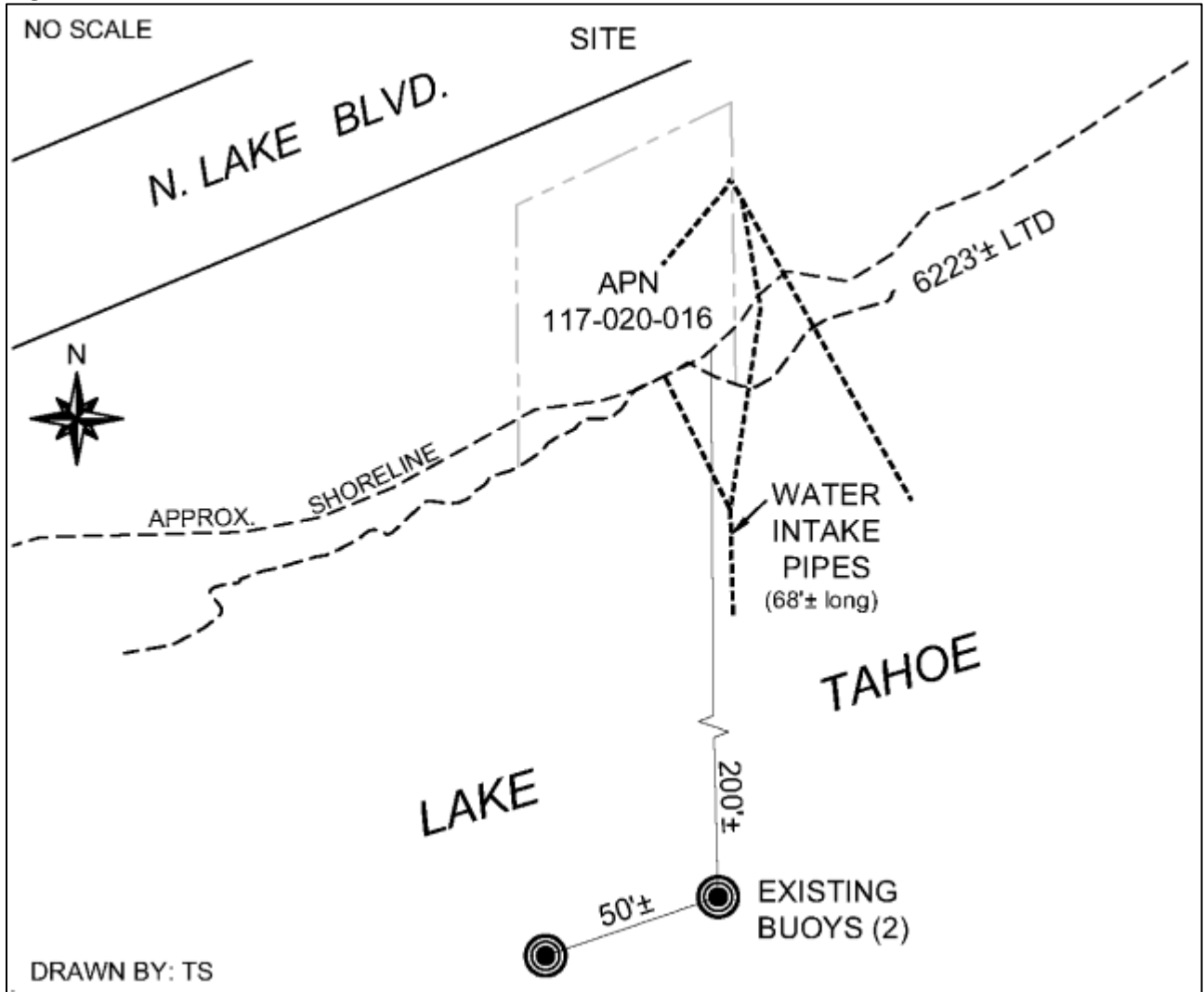

NOTE: This depiction of the lease premises is based on unverified information provided by the Applicant or other parties and is not a waiver or limitation of any State interest in the subject or any other property.

TERM:

10 years, beginning June 29, 2021.

CONSIDERATION:

\$768 per year, with an annual Consumer Price Index adjustment.

SPECIFIC LEASE PROVISIONS:

Liability insurance in an amount no less than \$1,000,000 per occurrence.

STAFF ANALYSIS AND RECOMMENDATION:

AUTHORITY:

Public Resources Code sections 6005, 6216, 6301, 6501.1, 6503, 6503.5, and 6505.5; California Code of Regulations, title 2, sections 2000 and 2003.

PUBLIC TRUST AND STATE'S BEST INTERESTS:

On June 29, 2021, the Commission authorized issuance of a General Lease – Recreational Use to Reynold J. DiLena for use and maintenance of two existing freshwater intake pipelines not previously authorized by the Commission; and two existing mooring buoys ([Item 7](#)). On February 28, 2023, the Commission authorized assignment of Lease 8431 to Tara Kassity and Daniel Kassity ([Item 14](#)). The Applicant was deeded the ownership of the upland property on August 20, 2025. Both buoys are currently registered with the Tahoe Regional Planning Agency (Registration No. 10837).

The Applicant is now applying for an Assignment of Lease, effective August 20, 2025, to coincide with the transfer of the upland property.

The Applicant is qualified to hold the lease, and staff has not discovered any information that would provide a basis for withholding the assignment. Thus, staff believes that assigning the lease is in the State's best interest to ensure that a capable lessee is committed to managing the improvements and fulfilling the lease obligations. The proposed assignment does not alienate the State's fee simple interest or permanently impair public rights.

CLIMATE CHANGE:

INTRODUCTION:

Climate change significantly affects inland non-tidal lakes such as Lake Tahoe, and its effects are increasing throughout the Sierra Nevada mountains. According to [California's Fourth Climate Change Assessment](#) (2018), the most significant impacts of climate change in the Sierra Nevada Region are more intense heat, precipitation extremes, declining snowpacks, and changes in streamflow timing.

These impacts create hazardous conditions like flooding, landslides, wildfire, drought, extreme heat, and severe storms. Structures along the shores of inland lakes are particularly vulnerable to the more frequent and extreme weather events, year-to-year changes in total precipitation, and shifts in seasonal characteristics.

DATA & PROJECTIONS:

Temperatures in the Sierra Nevada are expected to increase six to ten degrees Fahrenheit on average by the end of the century, causing the snowline to shift upslope 1,500 to 3,000 feet in elevation (California's Fourth Climate Change Assessment, 2018). The long-term warming trend will lead to warmer and shorter winters and longer and drier summers. The warmer winters will reduce winter snowpacks by up to 60 percent across most of the Sierra Nevada and will result in increased winter streamflows and floods and decreased spring and summer runoff. Loss of snowpack is expected to dry soils 15 to 40 percent below their historical norms. Hotter, drier summer seasons and low water years will increase stress to vegetation, elevating wildfire risk and fire severity in the Tahoe Basin.

Dry winters will be punctuated with exceedingly wet years and higher temperatures will result in more rain-on-snow events ([Integrated Vulnerability Assessment of Climate Change in the Lake Tahoe Basin](#), 2020). Atmospheric river systems will become more common. These events produce both flash floods and higher than normal seasonal flooding which may shift earlier in the year. Higher soil moisture will increase erosion and elevate landslide risk, particularly following intense wildfire seasons.

The lease is a 10-year General Lease – Recreational Use that began on June 29, 2021, and may be subject to the climate change effects provided above. Regular maintenance, as referenced in the lease, may reduce the likelihood of severe structural degradation and dislodgement. Further climate change impact analyses on the leased facilities would be assessed if a new lease is considered in 2031 and would be based on projected climate change scenarios at that time.

CONCLUSION:

For all the reasons above, staff believes the assignment of this lease will not substantially interfere with the Public Trust needs at this location, at this time, and for the term of the lease; and is in the best interests of the State.

OTHER PERTINENT INFORMATION:

1. Approval or denial of the application is a discretionary action by the Commission. Each time the Commission approves or rejects a use of sovereign land, it exercises legislatively delegated authority and responsibility as trustee of the State's Public Trust lands as authorized by law. If the Commission denies the application, the lease would not be assigned. The assignee has no right to a new lease or to renewal of any previous lease.
2. This action is consistent with the "Leading Climate Activism" and "Meeting Evolving Public Trust Needs" Strategic Focus Areas of the Commission's 2021-2025 Strategic Plan.
3. Assignment of lease is not a project as defined by the California Environmental Quality Act because it is an administrative action that will not result in direct or indirect physical changes in the environment.

Authority: Public Resources Code section 21065 and California Code of Regulations, title 14, sections 15060, subdivision (c)(3), and 15378, subdivision (b)(5).

RECOMMENDED ACTION:

It is recommended that the Commission:

PUBLIC TRUST AND STATE'S BEST INTERESTS:

Find that the proposed assignment of lease will not substantially impair the public rights to navigation and fishing or substantially interfere with Public Trust needs and values at this location, at this time, and for the term of the lease; and is in the best interests of the State.

AUTHORIZATION:

Authorize the assignment of Lease Number 8431, a General Lease – Recreational Use of sovereign land, from Tara Kassity and Daniel Kassity to Robert C. Ryan, III as Trustee of The Robert C Ryan, III Trust; Kelly J. Ryan, co-Trustees of the Robert C. and Helen J. Ryan Revocable Trust, dated October 15, 1992, effective August 20, 2025, to coincide with the Applicant's acquisition of the upland property.