

Staff Report 03

APPLICANT:

Jay Gudebski, Trustee of the Jay Gudebski Trust Agreement, dated August 25, 2008

PROPOSED ACTION:

Issuance of a General Lease – Recreational Use

AREA, LAND TYPE, AND LOCATION:

Sovereign land in Lake Tahoe, adjacent to 8315 Meeks Bay Avenue, Meeks Bay, El Dorado County.

AUTHORIZED USE:

Use and maintenance of two existing mooring buoys.

TERM:

10 years; beginning August 28, 2022.

CONSIDERATION:

\$546 per year, with an annual Consumer Price Index adjustment.

SPECIFIC LEASE PROVISIONS:

- Liability insurance in an amount no less than \$1,000,000 per occurrence.
- Lessee expressly acknowledges that a permit from the Tahoe Regional Planning Agency (TRPA) is required for the Authorized Improvements and failure to obtain a permit from TRPA and maintain compliance with that permit may result in TRPA imposing civil penalties and will constitute a breach of this lease.
- Lessee shall not store any personal items or construct any improvements in the Public Trust easement which may impair the public uses of access, navigation, fishing, and lake-related recreation.

STAFF ANALYSIS AND RECOMMENDATION:

AUTHORITY:

Public Resources Code sections 6005, 6216, 6301, 6501.1, 6503, 6503.5, and 6505.5; and California Code of Regulations, title 2, sections 2000 and 2003.

PUBLIC TRUST AND STATE'S BEST INTERESTS:

On September 20, 2013, the Commission authorized a 10-year General Lease – Recreational Use to Jay Gudebski, Trustee of the Jay Gudebski Trust Dated 8/25/2008, for two existing mooring buoys ([Item C41, September 20, 2013](#)). That lease will expire on August 27, 2022. The Applicant is applying for a General Lease – Recreational Use, for use and maintenance of two existing mooring buoys in Lake Tahoe. Based on the lease application and Commission records, the subject facilities have existed at this location for many years, as shown on prior lease exhibits. On January 27, 2022, the Lessee registered the moorings with TRPA under registration number 10393.

The subject facilities are privately owned and maintained by the Applicant. The facilities are used for recreational boating. Recreational boating is a water dependent use that is generally consistent with the common law Public Trust Doctrine. The California Legislature has identified private recreational boating facilities as an authorized use of Public Trust land. (Pub. Resources Code, § 6503.5.) The subject facilities are located directly lakeward of the upland property and occupy a relatively small area of the lake. The proposed lease will not interfere with navigation and does not substantially interfere with any Public Trust needs at this time or the foreseeable future. The proposed lease does not alienate the State's fee simple interest or permanently impair public rights. The lease is limited to a 10-year term, does not grant the lessee exclusive rights to the lease premises, and reserves an easement to the public for Public Trust-consistent uses. Upon termination of the lease, the lessee may be required to remove all improvements from State land and restore the lease premises to their original condition.

The proposed lease requires the lessee to insure the lease premises and indemnify the State for any liability incurred as a result of the lessee's activities thereon. The lease also requires the payment of annual rent to compensate the people of the State for the occupation of the public land involved.

CLIMATE CHANGE:

Climate change significantly affects inland non-tidal lakes such as Lake Tahoe. The frequency and severity of natural disasters like flooding, wildfire, drought, extreme

heat, and storms is increasing throughout the state of California, including the Sierra Nevada mountains, and will continue to accelerate through the end of the century. Structures along the shores of inland lakes are particularly vulnerable to the more frequent and extreme weather events and shifts in seasonal characteristics.

According to California's Fourth Climate Change Assessment, released in 2018, the most significant impacts of climate change in the Sierra Nevada Region are more intense heat, precipitation extremes, declining snowpacks, and changes in streamflow timing. The long-term warming trend will lead to warmer and shorter winters, and longer and dryer summers. Successive dry and warm winters are resulting in minimal snowpack, increased winter streamflows and floods, and decreased spring and summer runoff. Prolonged low lake levels will become normal. Low lake level conditions can create more expansive beaches and increased shoreline access in dry months. However, these conditions interfere with boat launching and mooring facilities. This impact is most noticeable where the facilities are sited on shallow, low gradient lake bottom locations.

Dry winters will be punctuated with exceedingly wet years where prolonged and excessive precipitation can produce flash floods. High precipitation in these years will result in higher lake levels, causing beaches to narrow and reducing public access. Extra saturation of the soil can increase erosion, especially following intense wildfire seasons. Surface runoff water may carry more sediment into the lake, adversely impacting water quality and clarity.

Climate change may also lead to more intense and unpredictable storm events and winds. These storms may deviate from prevailing wind patterns for the region. These winds can accelerate shoreline erosion in some areas or cause erosion in areas not typically subject to erosion. Additionally, these winds can increase wave damage on structures and boats along the lake.

Buoys authorized under this lease may require more frequent inspection and maintenance to ensure they are not displaced during storm events. Watercraft moored to buoys are also vulnerable to damage from high wind events and excessive waves.

CONCLUSION:

For all the reasons above, staff believes the issuance of this lease will not substantially interfere with Public Trust needs at this location, at this time, and for the foreseeable term of the lease; is consistent with the common law Public Trust Doctrine; and is in the best interests of the State.

OTHER PERTINENT INFORMATION:

1. Approval or denial of the application is a discretionary action by the Commission. Each time the Commission approves or rejects a use of sovereign land, it exercises legislatively delegated authority and responsibility as trustee of the State's Public Trust lands as authorized by law. The lessee has no right to a new lease or to renewal of any previous lease.
2. This action is consistent with the "Leading Climate Activism" and "Meeting Evolving Public Trust Needs" Strategic Focus Areas of the Commission's 2021-2025 Strategic Plan
3. Staff recommends that the Commission find that this activity is exempt from the requirements of the California Environmental Quality Act (CEQA) as a categorically exempt project. The project is exempt under Class 1, Existing Facilities; California Code of Regulations, title 2, section 2905, subdivision (a)(2).

Authority: Public Resources Code section 21084 and California Code of Regulations, title 14, section 15300 and California Code of Regulations, title 2, section 2905.

EXHIBITS:

- A. Land Description
- B. Site and Location Map

RECOMMENDED ACTION:

It is recommended that the Commission:

CEQA FINDING:

Find that the activity is exempt from the requirements of CEQA pursuant to California Code of Regulations, title 14, section 15061 as a categorically exempt project, Class 1, Existing Facilities; California Code of Regulations, title 2, section 2905, subdivision (a)(2).

PUBLIC TRUST AND STATE'S BEST INTERESTS:

Find that the proposed lease will not substantially impair the public rights to navigation and fishing or substantially interfere with the Public Trust needs and

values at this location, at this time, and for the foreseeable term of the lease; is consistent with the Public Trust Doctrine; and is in the best interests of the State.

AUTHORIZATION:

Authorize issuance of a General Lease – Recreational Use to the Applicant beginning August 28, 2022, for a term of 10 years, for the use and maintenance of two existing mooring buoys, as described in Exhibit A and shown on Exhibit B (for reference purposes only) attached and by this reference made a part hereof; annual rent in the amount of \$546, with an annual Consumer Price Index adjustment; and liability insurance in an amount no less than \$1,000,000 per occurrence.

EXHIBIT A

LEASE 8178

LAND DESCRIPTION

Two parcels of submerged lands situated in the bed of Lake Tahoe, lying adjacent to fractional Section 28, Township 14 North, Range 17 East, M.D.B.&M., as shown on Official Government Township Plat approved January 17, 1866, County of El Dorado, State of California, more particularly described as follows:

Two circular parcels of land, each being 50 feet in diameter, underlying two existing buoys lying adjacent to that parcel described in Grant Deed recorded August 28, 2012 as Document Number 2012-0082804 in Official Records of said County.

Accompanying plat is hereby made part of this description.

END OF DESCRIPTION

Prepared 05/31/2022 by the California State Lands Commission Boundary Unit.

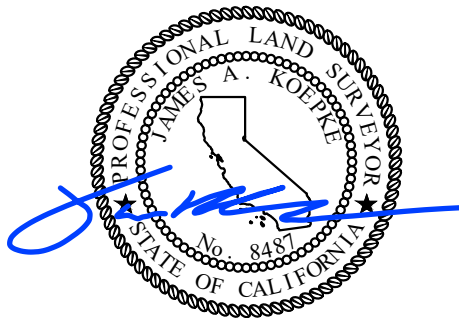

NO SCALE



APN 016-063-010

APPROX.
SHORELINE

6223'± LTD

EXISTING
PIER

112'±

EXISTING
BUOYS (2)

176'±

LAKE
TAHOE

EXHIBIT A

Page 2 of 2

TS 05/31/2022

LAND DESCRIPTION PLAT
LEASE 8178, GUDEBSKI TRUST
EL DORADO COUNTY

CALIFORNIA STATE
LANDS COMMISSION



