

Staff Report 47

LESSEE:

El Camino Boat Club, Inc.

PROPOSED ACTION:

Revision of Rent

AREA, LAND TYPE, AND LOCATION

0.165 acre+/- of State sovereign land in Little Potato Slough, adjacent to Assessor's Parcel Number 069-100-07, between Bouldin Island and Terminous Tract, San Joaquin County.

AUTHORIZED USE:

Continued use and maintenance of an armored submarine electric cable, fishing pier, and bank protection.

TERM:

20 years, beginning January 26, 2011.

CONSIDERATION:

This lease provides that Lessor may modify the rent periodically during the lease term. Pursuant to this provision, staff has conducted a review of the rent under this lease and recommends that rent be revised from \$575 per year to \$643 per year, effective January 26, 2022.

OTHER PERTINENT INFORMATION:

1. Approval or denial of the revision of rent is a discretionary action by the Commission. Each time the Commission approves or rejects a revision of rent, it exercises legislatively delegated authority and responsibility as trustee of the State's Public Lands as authorized by law. Upon expiration or prior termination of

the lease, the Lessee has no right to a new lease or to renewal of any previous lease.

2. On March 25, 2012, the Commission authorized a General Lease – Recreational, Protective Structure and Right-of-Way Use to El Camino Boat Club, Inc., for the continued use and maintenance of an armored submarine electric cable, fishing pier, and bank protection ([Item 65, March 29, 2012](#)). On August 19, 2015, the Commission approved ([Item 51, August 19, 2015](#)) an increase in the annual rent from \$150 to \$575, effective January 26, 2016. The lease will expire on January 25, 2031.
3. The parcel associated with the lease was redrawn as of April 25, 2013. The previous parcel was identified by the San Joaquin County Assessor's office as 069-030-15.
4. This action is consistent with the "Meeting Evolving Public Trust Needs" Strategic Focus Area of the Commission's 2021-2025 Strategic Plan.
5. Approving the revision of rent is not a project as defined by the California Environmental Quality Act because it is an administrative action that will not result in direct or indirect physical changes in the environment.

Authority: Public Resources Code section 21065 and California Code of Regulations, title 14, section 15378, subdivision (b)(5).

EXHIBIT:

A. Site and Location Map

RECOMMENDED ACTION:

It is recommended that the Commission:

AUTHORIZATION:

Approve the revision of rent for Lease Number PRC 3440 from \$575 per year to \$643 per year, effective January 26, 2022.

NO SCALE

SITE

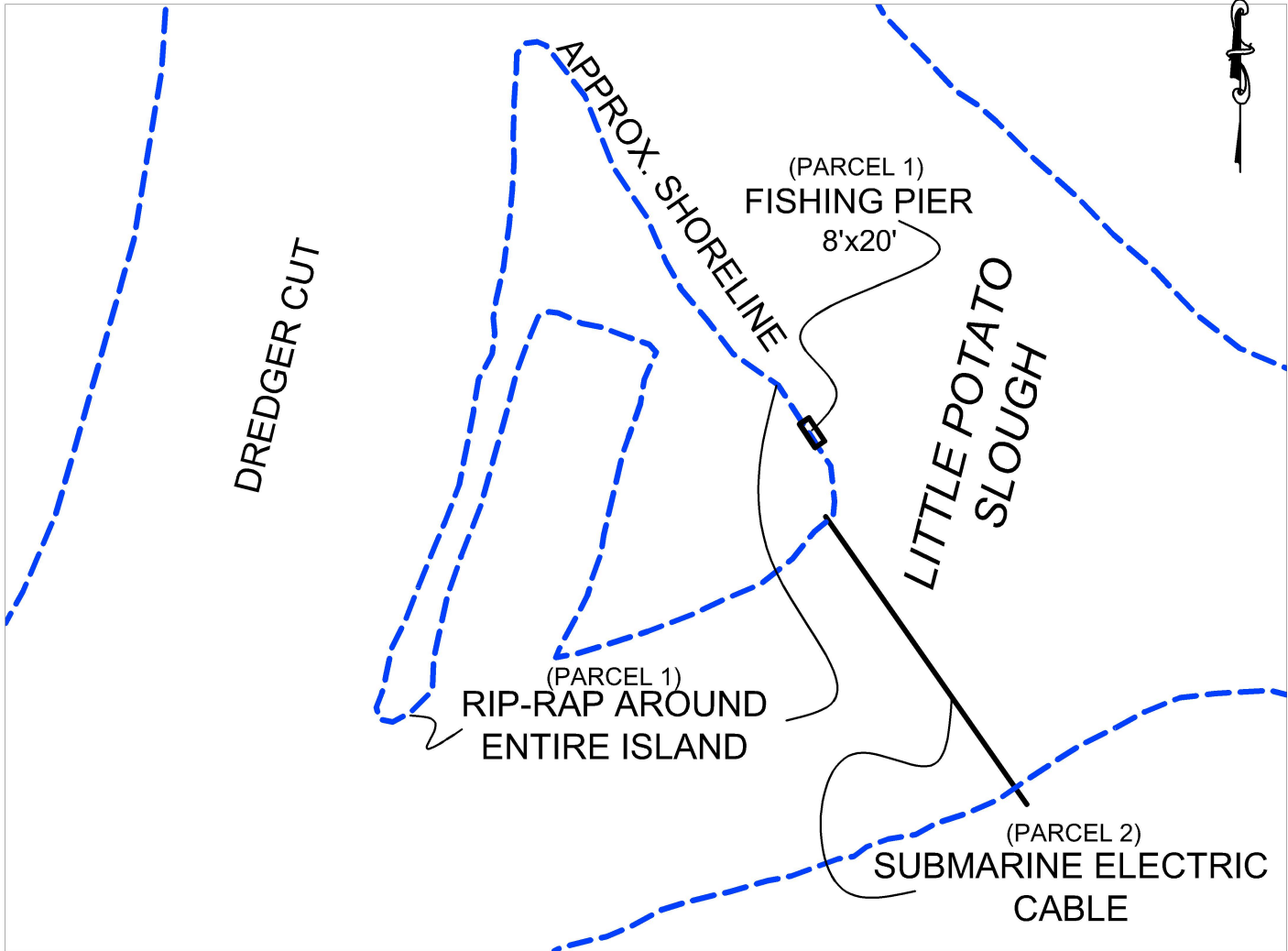

Little Potato Slough, near Terminous

NO SCALE

LOCATION

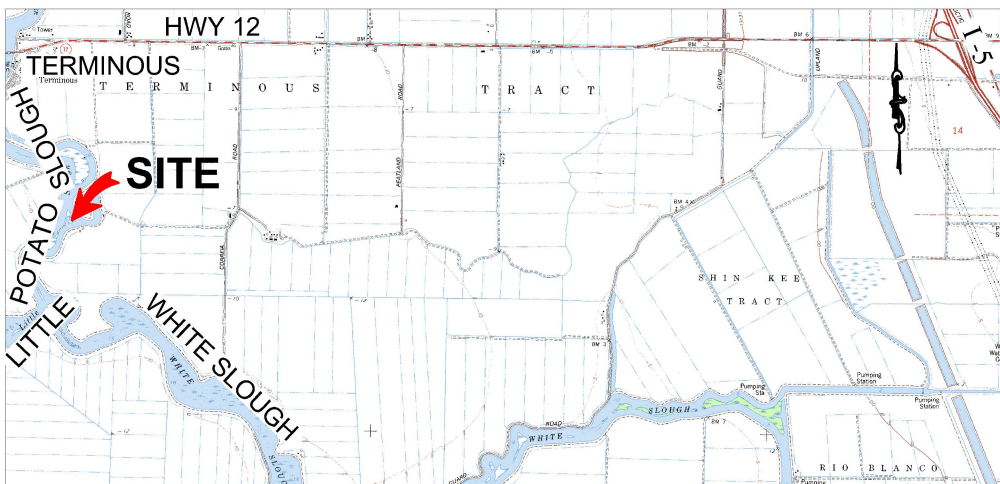

MAP SOURCE: USGS QUAD

Exhibit A

PRC 3440
EL CAMINO BOAT CLUB
APN 069-100-07
GENERAL LEASE -
RECREATIONAL, PROTECTIVE
STRUCTURE & RIGHT-OF-WAY USE
SAN JOAQUIN COUNTY



This Exhibit is solely for purposes of generally defining the lease premises, is based on unverified information provided by the Lessee or other parties and is not intended to be, nor shall it be construed as, a waiver or limitation of any State interest in the subject or any other property.

MJF 11/3/2021