

STAFF REPORT

21

A 2

04/29/20

S 2

PRC 4510.1

N. Lee

REVISION OF RENT

LESSEE:

PacifiCorp, dba Pacific Power

AREA, LAND TYPE, AND LOCATION:

Sovereign land in the Klamath River, adjacent to Assessor's Parcel Number 140-130-28, near Klamath, Del Norte County.

AUTHORIZED USE:

Continued use and maintenance of an existing overhead 12.5-kilovolt (kV) electrical power distribution line.

LEASE TERM:

25 years, beginning May 20, 2010.

CONSIDERATION:

This lease provides that the Commission may modify the rent periodically during the lease term. Pursuant to this provision, staff has conducted a review of the rent under this lease and recommends that rent be revised from \$450 per year to \$503 per year, effective May 20, 2020.

OTHER PERTINENT INFORMATION:

1. Approval or denial of the revision of rent is a discretionary action by the Commission. Each time the Commission approves or rejects a revision of rent, it exercises legislatively delegated authority and responsibility as trustee of the State's Public Trust lands as authorized by law. Upon expiration or prior termination of the lease, the Lessee has no right to a new lease or to renewal of any previous lease.
2. On June 23, 2011, the Commission authorized a General Lease – Right-of-Way Use to PacifiCorp, dba Pacific Power, beginning May 20, 2010, for the continued use and maintenance of an overhead 12.5-kV electrical power distribution line ([Item C63, June 23, 2011](#)). The lease will expire on May 19, 2035.

STAFF REPORT NO. **21** (CONT'D)

3. The action is consistent with Strategy 2.2 of the Commission's Strategic Plan to ensure timely receipt of revenues and royalties from the use and development of State lands and minerals.
4. Approving the revision of rent is not a project as defined by the California Environmental Quality Act because it is an administrative action that will not result in direct or indirect physical changes in the environment.

Authority: Public Resources Code section 21065 and California Code of Regulations, title 14, section 15378, subdivision (b)(5).

EXHIBIT:

- A. Site and Location Map

RECOMMENDED ACTION:

It is recommended that the Commission:

AUTHORIZATION:

Approve the revision of rent for Lease No. PRC 4510.1 from \$450 per year to \$503 per year, effective May 20, 2020.

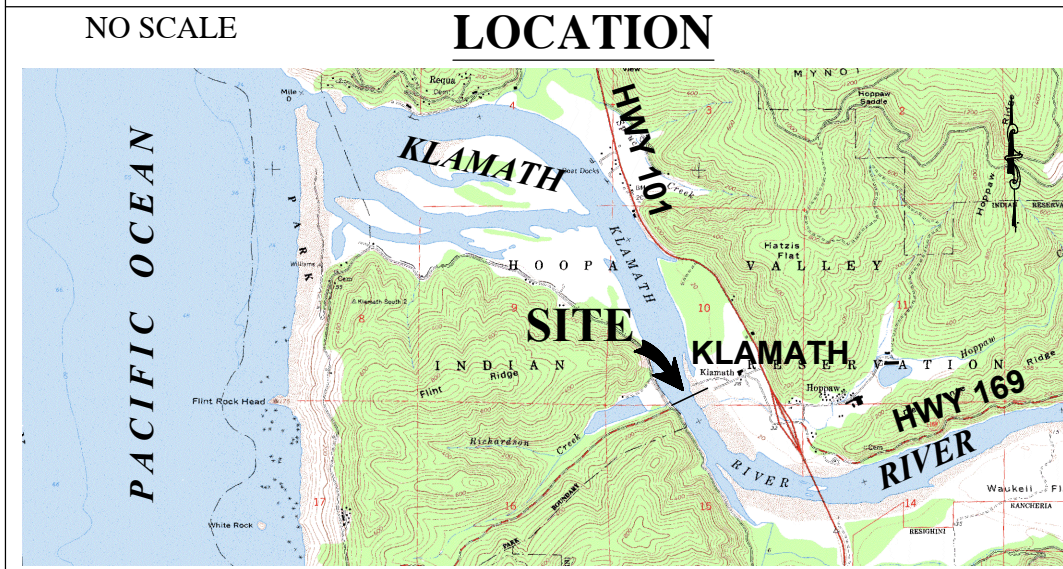
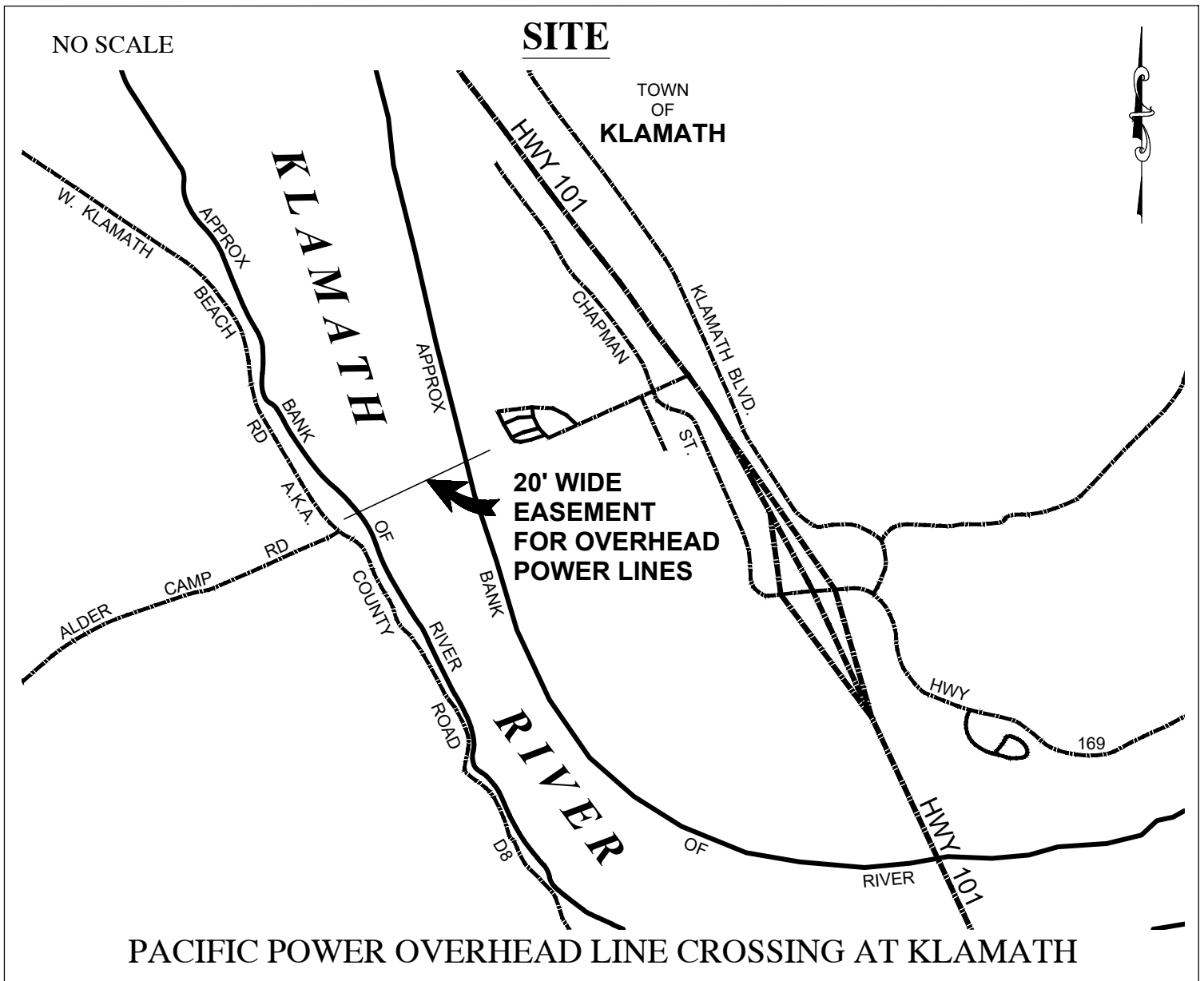

Exhibit A
 PRC 4510.1
 PACIFICORP
 APN 140-130-28
 GENERAL LEASE -
 RIGHT OF WAY USE
 DEL NORTE COUNTY



This Exhibit is solely for purposes of generally defining the lease premises, is based on unverified information provided by the Lessee or other parties and is not intended to be, nor shall it be construed as, a waiver or limitation of any State interest in the subject or any other property.