

STAFF REPORT

17

A 1

04/29/20
Lease 8457.1
A2389
S. Avila

S 1

GENERAL LEASE – RECREATIONAL USE

APPLICANT:

Victor L. Metas and Shirley F. Metas, Trustees of the Metas Trust dated June 17, 1998; William A. Reinhard; Norma R. Calonico, Trustee of the Remo T. Calonico and Norma R. Calonico Revocable Trust dated May 1, 2013; and Susan Scannell

PROPOSED LEASE:

AREA, LAND TYPE, AND LOCATION:

Sovereign land in Lake Tahoe, adjacent to 6010 and 6020 North Lake Boulevard, near Agate Bay, Placer County.

AUTHORIZED USE:

Continued use and maintenance of an existing joint-use pier and four mooring buoys.

LEASE TERM:

10 years beginning August 20, 2020.

CONSIDERATION:

\$2,589 per year, with an annual Consumer Price Index adjustment.

SPECIFIC LEASE PROVISIONS:

- Liability insurance in an amount no less than \$1,000,000 per occurrence.
- Lessee expressly acknowledges and agrees that issuance of a lease does not substitute for, or provide preference in, obtaining authorizations from the Tahoe Regional Planning Agency (TRPA) or any other regulatory agency for the improvements authorized by the Commission.
- Lessee shall not store any personal items or construct any

STAFF REPORT NO. 17 (CONT'D)

improvements in the Public Trust easement which may impair the public uses of access, navigation, fishing and lake-related recreation.

STAFF ANALYSIS AND RECOMMENDATION:

Authority:

Public Resources Code sections 6005, 6216, 6301, 6501.1, 6503, and 6503.5; California Code of Regulations, title 2, sections 2000 and 2003.

Public Trust and State's Best Interests Analysis:

On August 20, 2010, the Commission authorized a Recreational Pier Lease for the continued use and maintenance of an existing joint-use pier and four mooring buoys to Victor Metas and Shirley Metas; William W. Reinhard; Norma T. Calonico; and Susan Scannell ([Item C02, August 20, 2010](#)).

Since that time, portions of the fee interest in the upland parcels transferred to trusts within the Applicant's family. The lease will expire on August 19, 2020. The Applicant is applying for a General Lease – Recreational Use, for the continued use and maintenance of the existing joint-use pier and four mooring buoys. In October and November of 2019, the Lessee registered the mooring buoys with TRPA (Permit Nos. 10827 and 10883).

The Applicant owns the uplands adjoining the lease premises. The subject facilities are privately owned and maintained. The pier and mooring buoys are used for the docking and mooring of boats. Recreational boating is a water-dependent use that is generally consistent with the common law Public Trust Doctrine. The California Legislature has identified private recreational boating facilities as an authorized use of Public Trust land (Pub. Resources Code, § 6503.5).

The pier and mooring buoys have existed for many years at this location. The pier is built on single pilings with the immediate area of the pier surrounded by pebbles and small boulders. The topography and location of upland structures allows for public access for pedestrians and lake-related activities at varying water levels underneath the pier. The buoys are located directly lakeward of the upland property and occupy a relatively small area of the lake.

The proposed lease does not alienate the State's fee simple interest, or permanently impair public rights. The lease is limited to a 10-year term and does not grant the lessee exclusive rights to the lease premises and

STAFF REPORT NO. 17 (CONT'D)

reserves an easement to the public for Public Trust-consistent uses. Upon termination of the lease, the lessee may be required to remove all improvements from State land and restore the lease premises to their original condition.

The proposed lease requires the lessee to insure the lease premises and indemnify the State for any liability incurred as a result of the lessee's activities thereon. The lease also requires the payment of annual rent to compensate the people of the State for the occupation of the public land involved.

For all the reasons above, staff believes the issuance of this lease will not substantially interfere with Public Trust needs at this location, at this time, and for the foreseeable term of the proposed lease; and is in the best interests of the State.

OTHER PERTINENT INFORMATION:

1. Approval or denial of the application is a discretionary action by the Commission. Each time the Commission approves or rejects a use of sovereign land, it exercises legislatively delegated authority and responsibility as trustee of the State's Public Trust lands as authorized by law. If the Commission denies the application, the Applicant may be required to remove the pier and four mooring buoys and restore the premises to their original condition. Upon expiration or prior termination of the lease, the lessee also has no right to a new lease or to renewal of any previous lease.
2. This action is consistent with Strategy 1.1 of the Commission's Strategic Plan to deliver the highest levels of public health and safety in the protection, preservation, and responsible economic use of the lands and resources under the Commission's jurisdiction, and Strategy 1.3 to promote, expand, and enhance appropriate public use and access to land along the State's inland and coastal waterways.
3. On October 24, 2018, the TRPA Governing Board certified a Final Environmental Impact Statement and adopted Lake Tahoe Shorezone Ordinance Amendments.
4. Staff recommends that the Commission find that this activity is exempt from the requirements of the California Environmental Quality Act (CEQA) as a categorically exempt project. The project is exempt under Class 1, Existing Facilities; California Code of Regulations, title 2, section 2905, subdivision (a)(2).

STAFF REPORT NO. 17 (CONT'D)

Authority: Public Resources Code section 21084 and California Code of Regulations, title 14, section 15300 and California Code of Regulations, title 2, section 2905.

EXHIBITS:

- A. Land Description
- B. Site and Location Map

RECOMMENDED ACTION:

It is recommended that the Commission:

CEQA FINDING:

Find that the activity is exempt from the requirements of CEQA pursuant to California Code of Regulations, title 14, section 15061 as a categorically exempt project, Class 1, Existing Facilities; California Code of Regulations, title 2, section 2905, subdivision (a)(2).

PUBLIC TRUST AND STATE'S BEST INTERESTS:

Find that the proposed lease will not substantially impair the public rights to navigation and fishing or substantially interfere with the Public Trust needs and values at this location, at this time, and for the foreseeable term of the lease; is consistent with the Public Trust Doctrine; and is in the best interests of the State.

AUTHORIZATION:

Authorize issuance of a General Lease – Recreational Use to the Applicant beginning August 20, 2020, for a term of 10 years, for the continued use and maintenance of an existing joint-use pier and four mooring buoys, as described in Exhibit A and shown on Exhibit B (for reference purposes only) attached and by this reference made a part hereof; annual rent in the amount of \$2,589, with an annual Consumer Price Index adjustment; and liability insurance in an amount no less than \$1,000,000 per occurrence.

EXHIBIT A

LEASE 8457.1

LAND DESCRIPTION

Five (5) parcels of submerged land situate in the bed of Lake Tahoe, lying adjacent to Lot 4 of fractional Section 14, Township 16 North, Range 17 East, MDM., as shown on Official Government Township Plat approved November 10, 1865, County of Placer, State of California, and more particularly described as follows:

PARCEL 1 – PIER

All those lands underlying an existing Joint-Use pier with two (2) catwalks lying adjacent to that parcel as described in that Grant Deed recorded August 24, 2010 as Document Number 2010-0066038 and that parcel described in that Grant Deed recorded June 5, 2013 as Document Number 2013-0055068 in Official Records of said County.

TOGETHER WITH any applicable impact area(s).

EXCEPTING THEREFROM any portion(s) lying landward of elevation 6223 feet LTD on the shoreline of said Lake Tahoe.

PARCEL 2, 3, 4, & 5

Four (4) circular parcels of land, being 50 feet in diameter, underlying four (4) existing buoys lying adjacent to said parcels.

Accompanying plat is hereby made part of this description.

END OF DESCRIPTION

Prepared January 23, 2020 by the California State Lands Commission Boundary Unit.



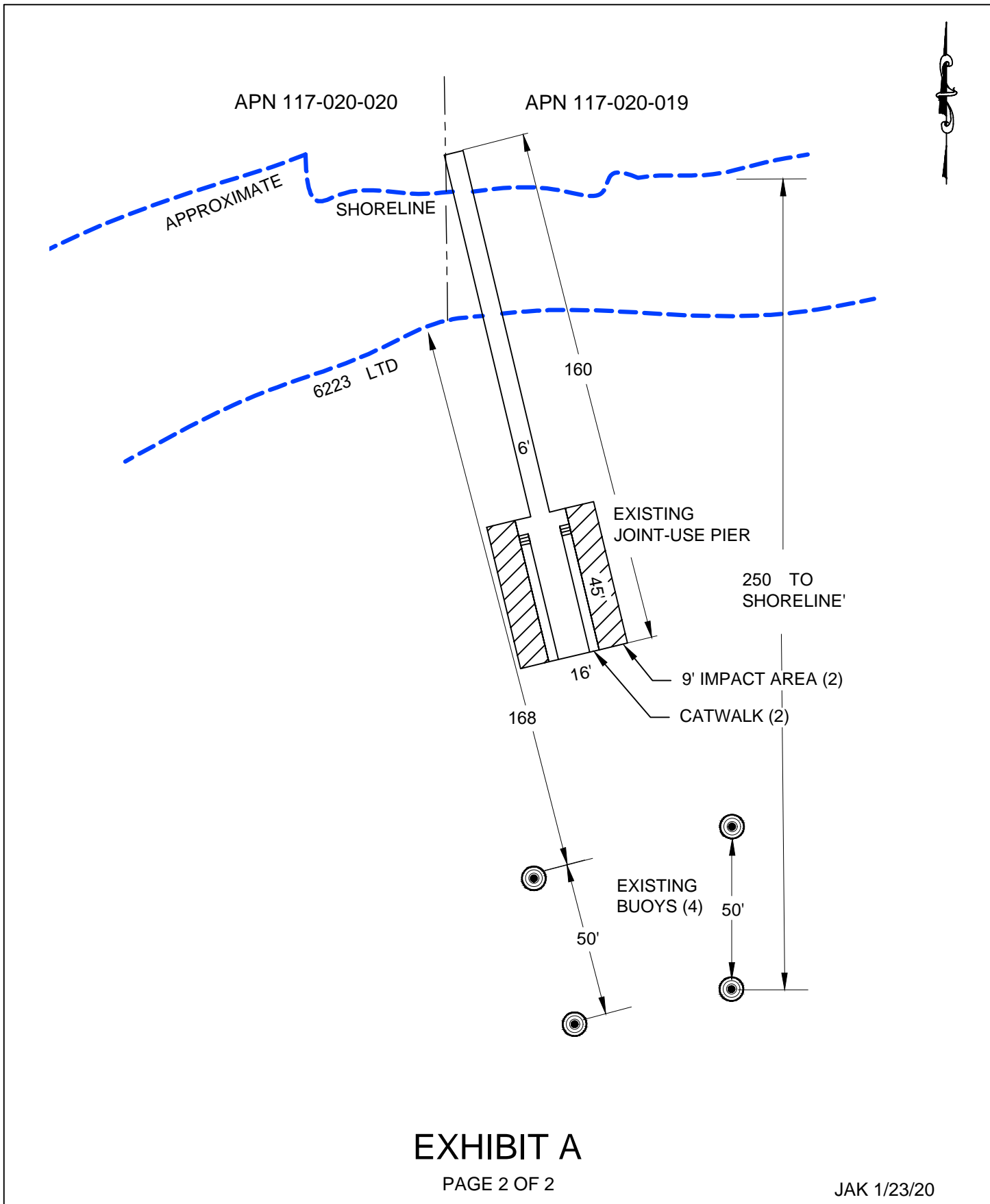

LAND DESCRIPTION PLAT
LEASE 8457.1, METAS & CALONICO
TRUSTS, PLACER COUNTY

CALIFORNIA STATE
LANDS COMMISSION



NO SCALE

SITE

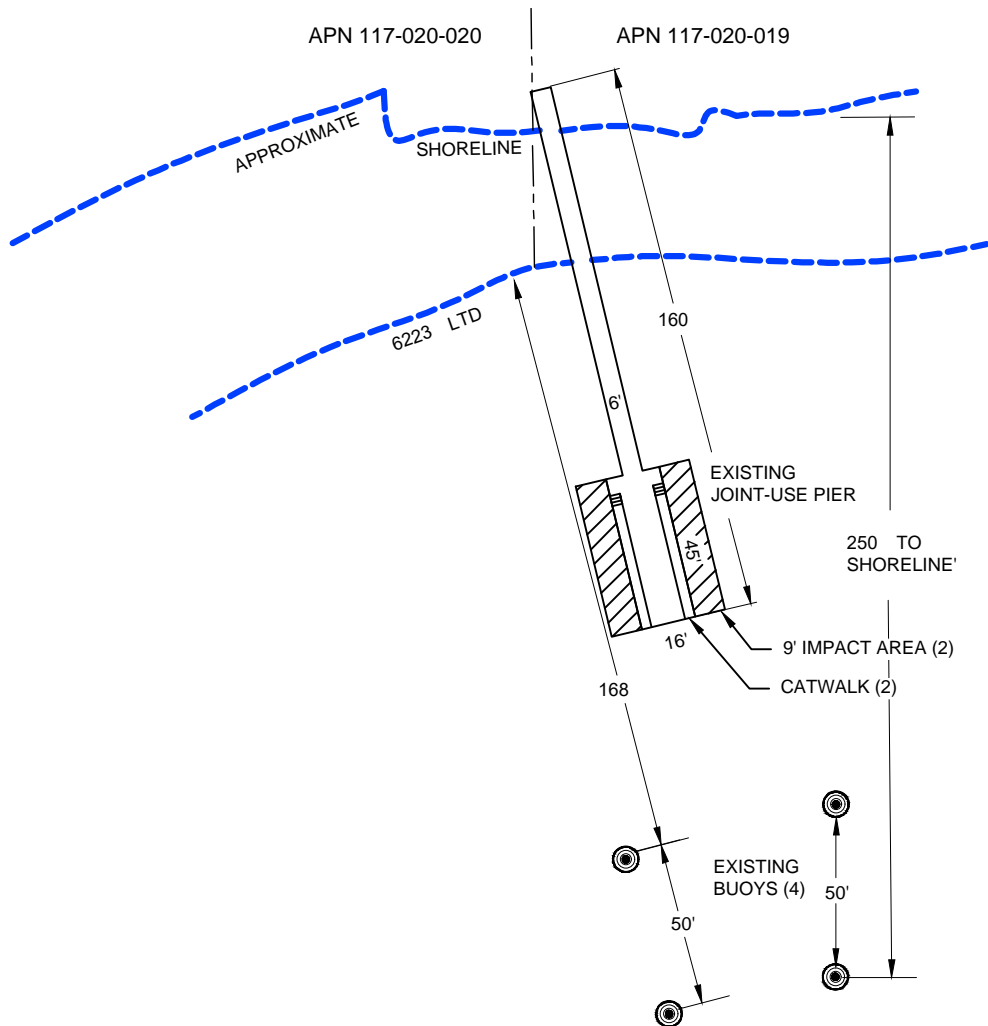

6010 & 6020 NORTH LAKE BLVD., AGATE BAY

NO SCALE

LOCATION



THIS EXHIBIT IS SOLELY FOR PURPOSES OF GENERALLY DEFINING THE LEASE PREMISES, IS BASED ON UNVERIFIED INFORMATION PROVIDED BY THE LESSEE OR OTHER PARTIES AND IS NOT INTENDED TO BE, NOR SHALL IT BE CONSTRUED AS, A WAIVER OR LIMITATION OF ANY STATE INTEREST IN THE SUBJECT OR ANY OTHER PROPERTY.

EXHIBIT B

LEASE 8457.1
METAS AND CALONICO
TRUSTS
APN 117-020-019 & 020
GENERAL LEASE -
RECREATIONAL USE
PLACER COUNTY

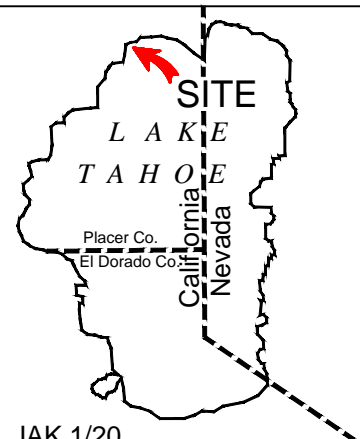

JAK 1/20